

Preparing to do the test

- Open the box and you will get the components shown below.

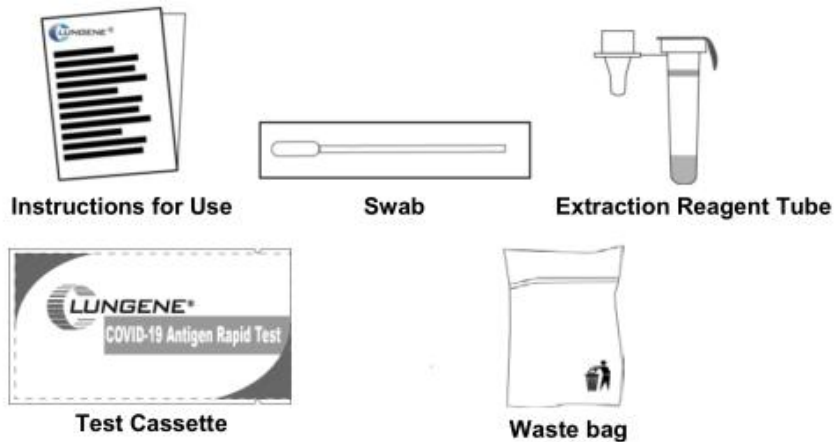

- Wash your hands in soapy water and dry thoroughly.

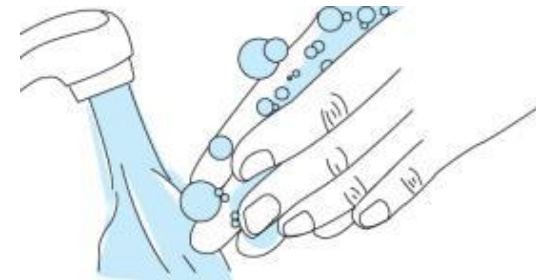

Step-By-Step Instructions

1. Open Extraction Reagent Tube

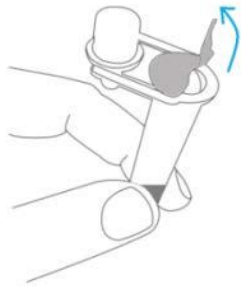

2. Insert Tube into Box

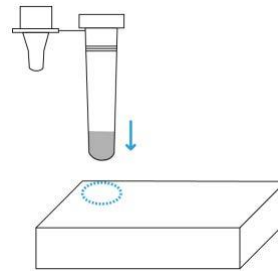

3. Remove the Swab

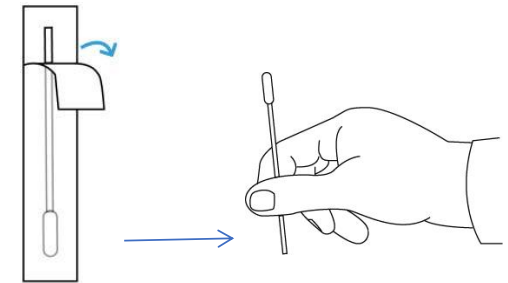

4. Swab the Left Nostril

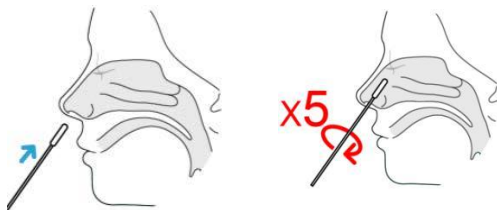

5. Swab the Right Nostril

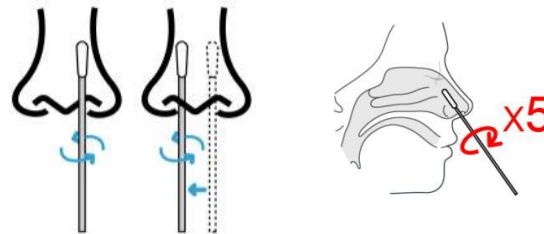

6. Insert the Swab into the Tube

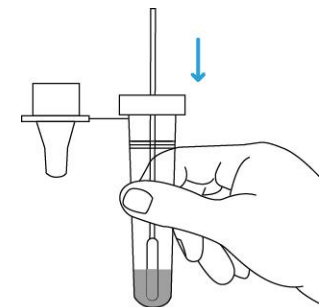

(Approximately 1.5 times the length of the swab tip)

Step-By-Step Instructions

7. Rotate the Swab 5 Times

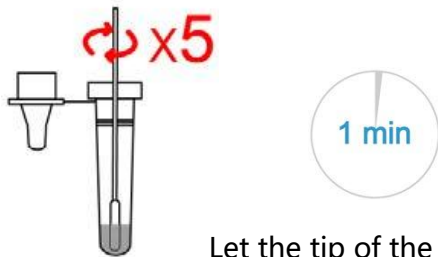

Let the tip of the swab soak in the tube for 1 minute.

8. Remove the Swab

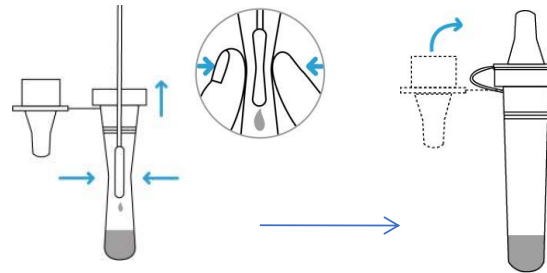

9. Take out the Test Cassette from the pouch

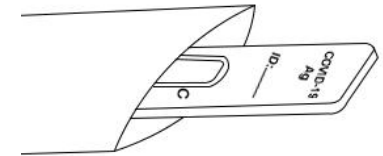

10. Add Sample to the Sample Well

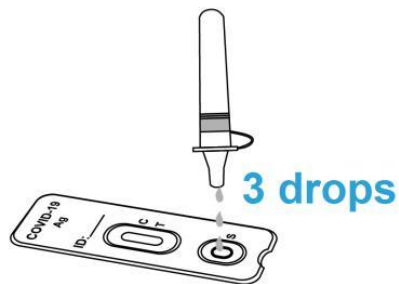

11. Start the timer and wait 15 minutes.

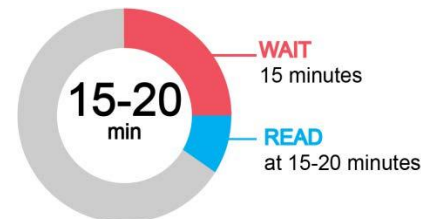

Read the test result at **15-20** minutes.

DO NOT read the result after 20 minutes.



Read result

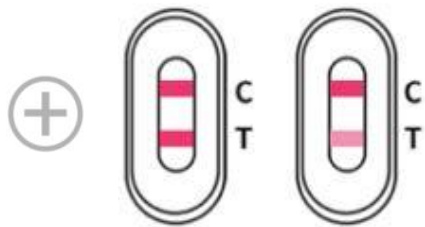

Positive Result

Two lines appear.

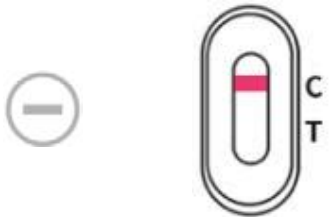

Negative Result

One coloured line appears at the control region (C), and no line appears at the test region (T).



Invalid Result

Control (C) line fails to appear.

Dispose of the used test kit

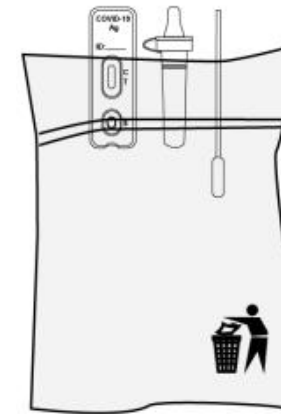

Collect all parts of the test kit and place in the waste bag that can be placed in the general waste.